

36 Latrobe Court CAULFIELD SOUTH VIC

2 1 1

Superbly situated on an outstanding allotment of 641m² in this quiet court, this attractive light and bright brick veneer sits proudly on this excellent allotment which all adds up to a recipe for success.

The house itself comprises: entrance hall, two double bedrooms with built in robes, spacious lounge and dining area, kitchen/meals, bathroom, laundry and single lock up garage.

Ideal location only 300m to tram, an easy walk to Glenhuntly station and shops, Princes Park and Caulfield South Primary.

Move straight in and enjoy, or add some extra touches and

Type : House
Land Size : 641 sqm
View : <https://www.jacain.com.au/sale/vic/east/caulfield-south/residential/house/7491054>



Chris Cain
03 9805 2900

[For full version visit the website](https://www.jacain.com.au)

36 Latrobe Court Caulfield South

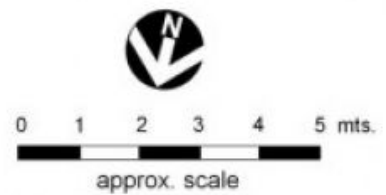
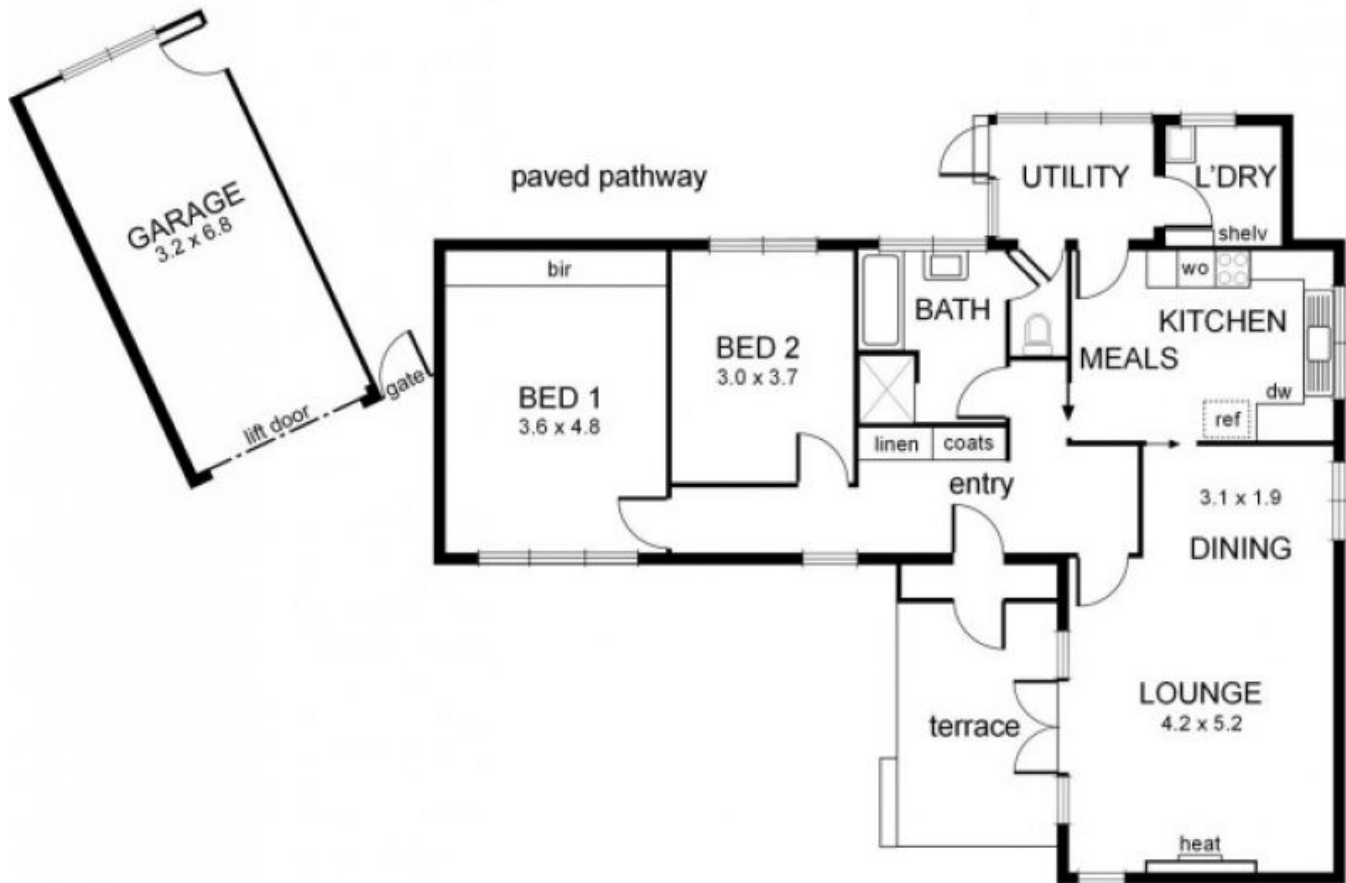

NB: All possible care is taken with measurements however it should be assumed that they are approximations and are not definitive

This plan is a guide only, not a detailed specification