



## 50 Gardiner Parade GLEN IRIS VIC

5 2 2

Occupying the treasured northern juncture of Gardiner Parade and Howard Street, this imposing location is one of the most coveted corner properties in Glen Iris. Adjacent to Nettleton Park and Gardiners Creek walking trail, this home is among some of the area's most prestigious residences and offers the possibility to develop (STCA), build a brand-new dream home, invest or occupy this charming solid brick residence.

Only a short walk to Glen Iris or Gardiner train station, Burke Road or High Street tram and with easy access to Monash Freeway and some of Melbourne's leading schools, makes this position extremely family friendly.

The residence can cater for a large family through five bedrooms and two bathrooms with formal lounge and separate dining rooms creating the perfect peaceful retreat. Open plan kitchen and family zones, opens onto outdoor entertaining areas which include rear studio and delightful

**View :** <https://www.jacain.com.au/sale/vic/east/glen-iris/residential/house/7491108>



**Chris Cain**  
03 9805 2900

# 50 Gardiner Parade Glen Iris

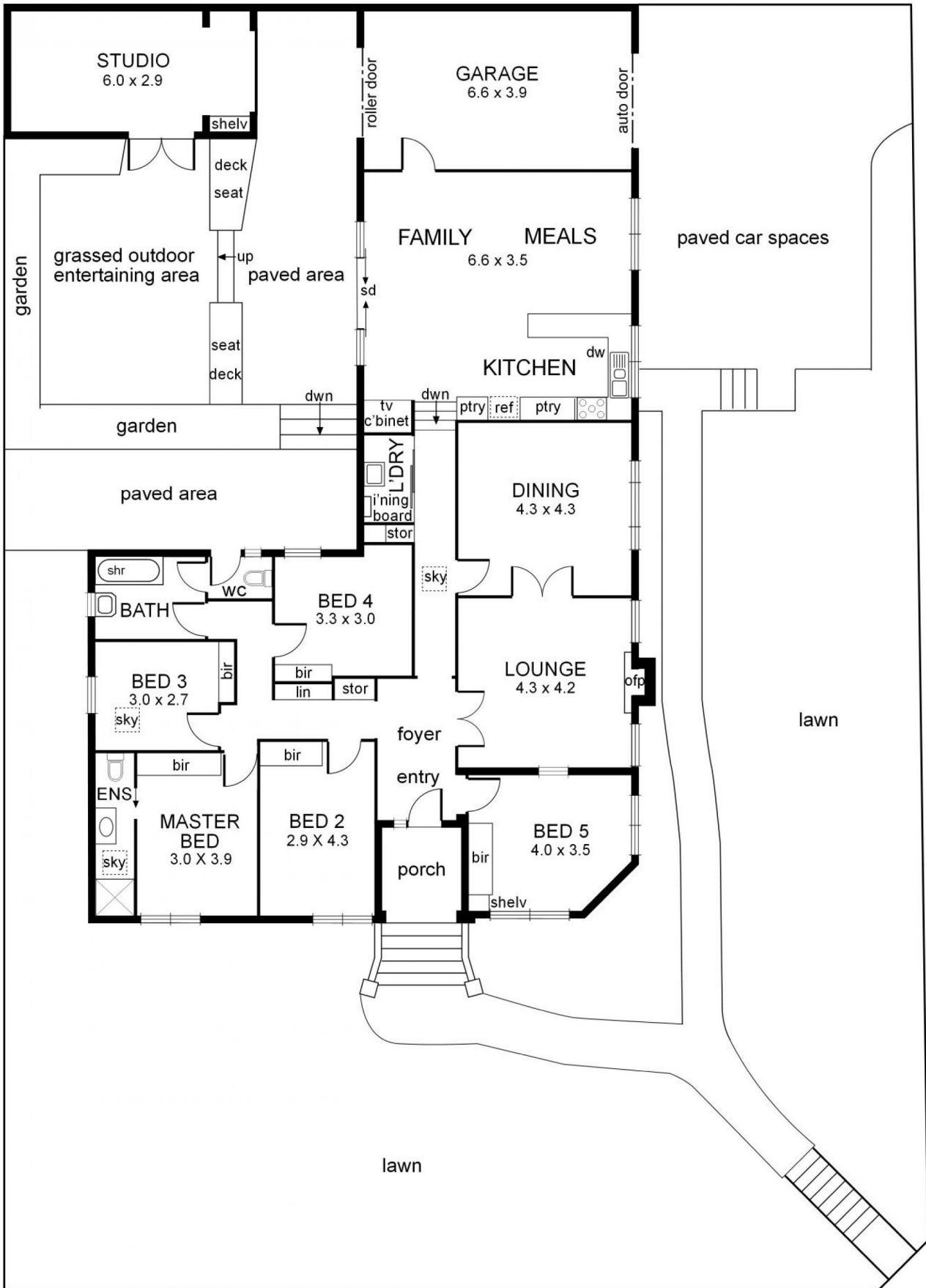

HOWARD STREET

0 1 2 3 4 5 mts.  
approx. scale

GARDINER PARADE

NB: All possible care is taken with measurements however it should be assumed that they are approximations and are not definitive



This plan is a guide only, not a detailed specification

Particulars herein are for information only and do not constitute representation by the Owner or Agent