



14 Yardley Drive Wheelers Hill VIC

4 2 8

JA CAIN is delighted to present 14 Yardley Drive Wheelers Hill.

Located on the high exposure corner of Wellington Road and Yardley Drive, this immaculate property presents exciting possibilities to:

- Occupy and immediately commence in a medical facility
- Lease out at an optimal rental
- Re-develop (STA)
- Convert into a sizeable residential residence

Building Size: 138sqm approx..

Land Size: 662sqm approx..

Key Features:

- Vacant possession available

Building Size : 138 sqm
Land Size : 662 sqm
View : <https://www.jacain.com.au/sale/vic/east/wheelers-hill/residential/house/8040415>



Chris Cain
03 9805 2900



Bryan Cain
03 9805 2900

14 Yardley Drive Wheelers Hill

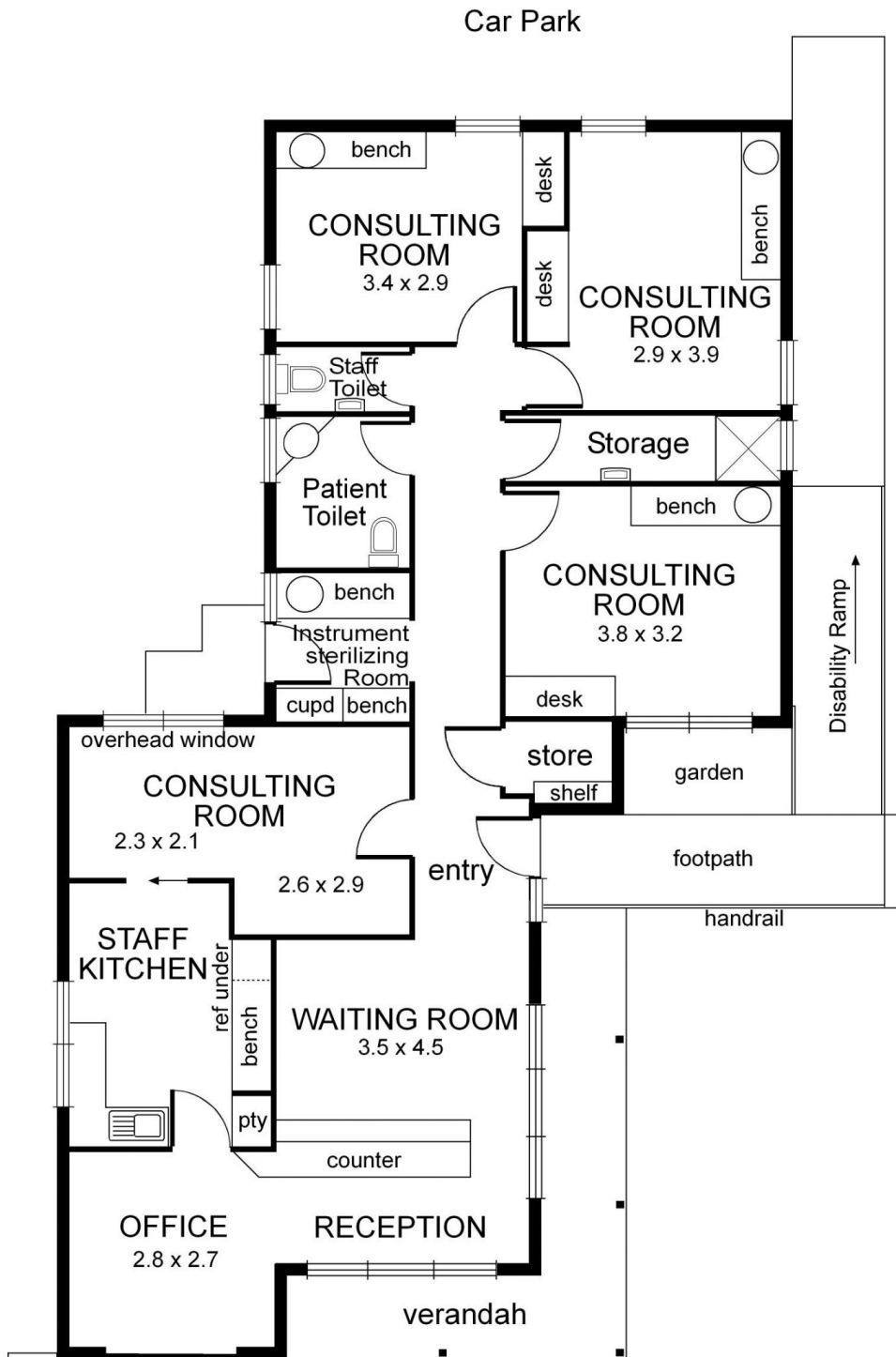

approx. scale

NB: All possible care is taken with measurements however it should be assumed that they are approximate and are not definitive, and no liability will be accepted for any misinformation.

This plan is a guide only, not a detailed specification

14 Yardley Drive Wheelers Hill

