



1/20 Douglas Street Ashwood VIC

2 **2** **1**

Once an original family house on a deep block, this charming clinker brick single level residence now occupies a large front position on a sizable allotment and has been completely transformed to produce a stunning home in immaculate condition from front to rear.

Maintaining its impressive size and high ceilings plus a number of classic features throughout, the modern interior and landscaped outdoor areas provide comfort and privacy in a sophisticated and supremely peaceful setting.

The sizeable floorplan commences through entrance hallway which leads to open plan living and dining room that face favourably to the north for optimal natural sunlight. Adjoining the dining, is the gourmet kitchen that boasts

Type : Townhouse

Price : \$1,325,000

View : <https://www.jacain.com.au/sale/vic/east/ashwood/residential/townhouse/8163091>



Chris Cain
03 9805 2900



Sherwin Liang
0398052900

[For full version visit the website](https://www.jacain.com.au)

1/20 Douglas Street Ashwood

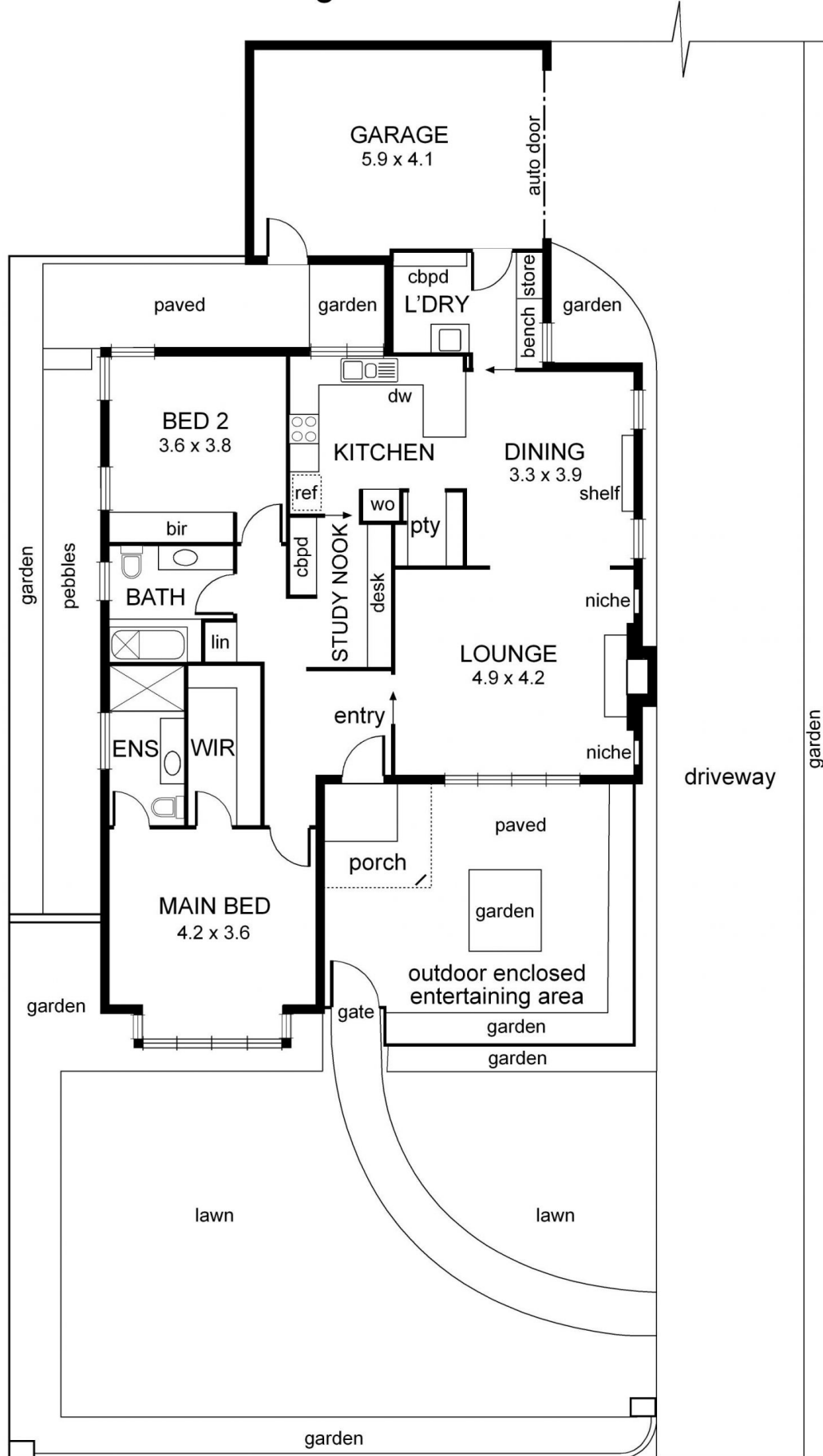

0 1 2 3 4 5 mts.

approx. scale

NB: All possible care is taken with measurements however it should be assumed that they are approximate and are not definitive, and no liability will be accepted for any misinformation.

This plan is a guide only, not a detailed specification

Particulars herein are for information only and do not constitute representation by the Owner or Agent